

Tact Switch

Q-2506

TYPE: **TC-0202**



SPECIFICATIONS

Contact Type	SPST
Rating	DC 12V, 50mA
Contacts Resistance	≤0,03MΩ
Insulation Resistance	≥100MΩ Min
Minimum Load	DC 500V
Dielectric Strengths	AC 250V / 1 minute
Life Test	100 000 Cycles Min
Operating temperature range	-25°C to +70°C
Operating Force	130 ± 50gf

Outline Drawing

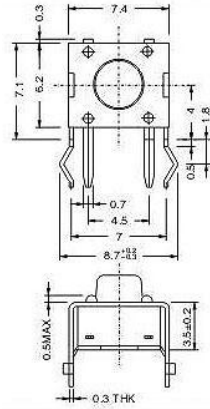

Mounting

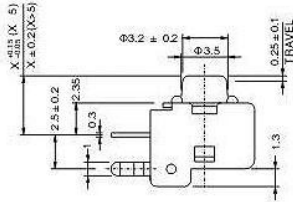

X= 5,0; 7,0; 8,0;9,5; 13,0mm
Circuitry

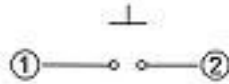

OFF - (ON)